

## DIN Mount Installation Instructions

Kit Number	Product	Package Contents
250-5099-005	Viper, HiPR-900, Phantom II	Mounting plate w/ spring, 8 screws, 4 lock washers, 4 nuts
250-5800-408	Integra	Mounting plate w/ spring, 4 screws
250-5800-406	T-96SR, DL-3400, SPC or DL-3282	Mounting plate w/ spring, 4 screws
250-5800-410	Vanguard SC/3000	Mounting plate w/ spring, 4 screws, 4 lock washers

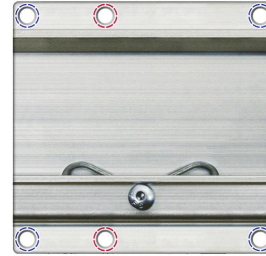

Four screw hole locations for Integra



--- Four screw-hole locations for T-96SR and DL-3400  
--- Four screw-hole locations for DL-3282 and SPC



--- Four screw-hole locations for Viper and HiPR-900  
--- Four screw-hole locations for Phantom II

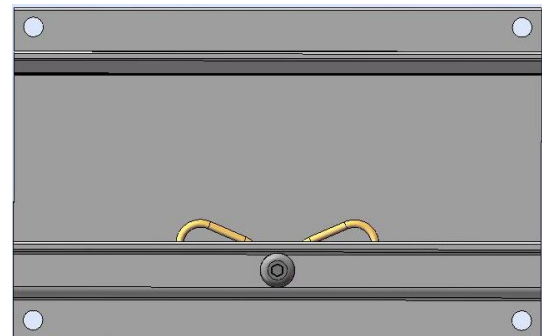

Four screw-hole locations for Vanguard

### Mounting the Vanguard, Viper, Integra, T-96SR, DL-3400, DL-3282 and SPC

1. Remove and discard original mounting plate and screws from the device.
2. Use screws (and toothed washers if supplied) included in this kit to attach the radio to the mounting plate using holes shown above. Screws should be inserted into the mounting plate from the side with DIN clips.
3. Snap mounting plate to DIN rail.

### Mounting the Phantom II

1. Mount the device to the mounting plate using four screws, lock washers, and nuts as shown right. Position the spring wire of the mounting plate facing the Phantom II RS232 antenna connector.

